

## Room 8, 210 Iffley Road, Oxford, OX4 1SE

£680 Per Month - 6th February 2026.

- Recently renovated
- Some bills included
- EPC E
- Council tax included

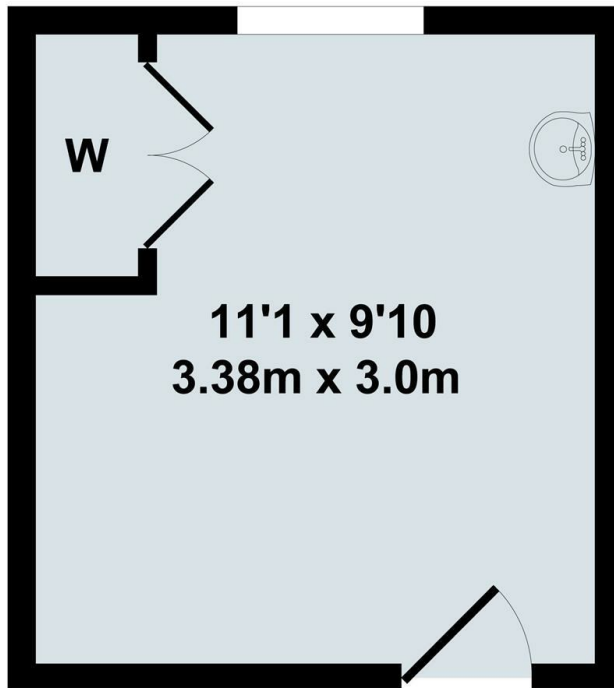

Total Approx. Floor Area 109 Sq.Ft. (10.10 Sq.M.)  
All items illustrated on this plan are included in the "Total Approx Floor Area"

## Directions

## Viewings

Viewings by arrangement only. Call 01865 515900 to make an appointment.

## Council Tax Band

## EPC Rating:

E

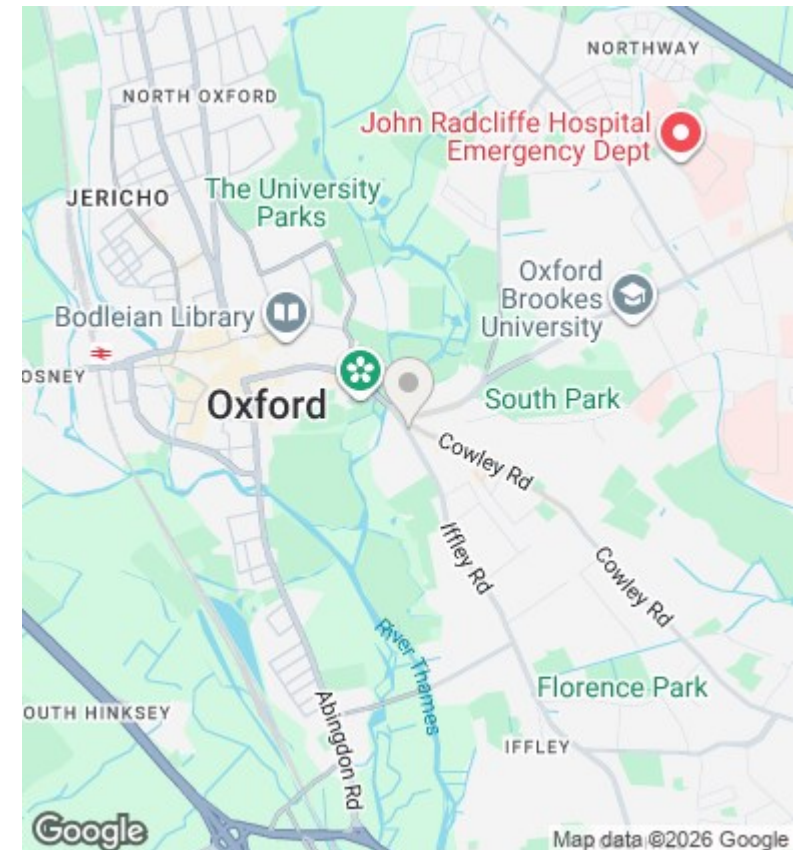

Energy Efficiency Rating		
	Current	Potential
Very energy efficient - lower running costs		
(92 plus) A		
(81-91) B		
(69-80) C		77
(55-68) D		
(39-54) E	46	
(21-38) F		
(1-20) G		
Not energy efficient - higher running costs		
England & Wales		EU Directive 2002/91/EC